



mod-u



Dimensioni espresse in millimetri
 Potenza espressa in Watt
 Radiatore in alluminio
 * Radiatore H 800 con cover superiore.

Dimension expressed in millimetres
 Output expressed in Watt
 Aluminium radiator
 * H800 radiator provided with top cover.

	H (mm)	D (mm)	L (mm)	 (lt)	 (W)	 (W)	 (W)	 (mm)	 RAL	 LUX-SAT-MAT
H 800	800	90	800	1,8	1000	550	800	890 + 740		
H 1800	1800	90	500	2,6	1400	770	1350	590 + 1740		

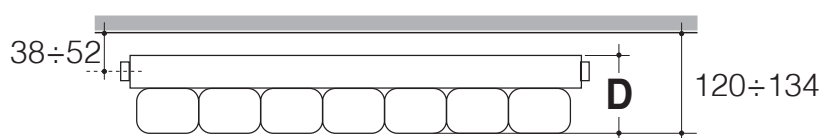

Valvola e detentore
 "Cilindro" a squadra
 "Cilindro" square
 valve and lockshield

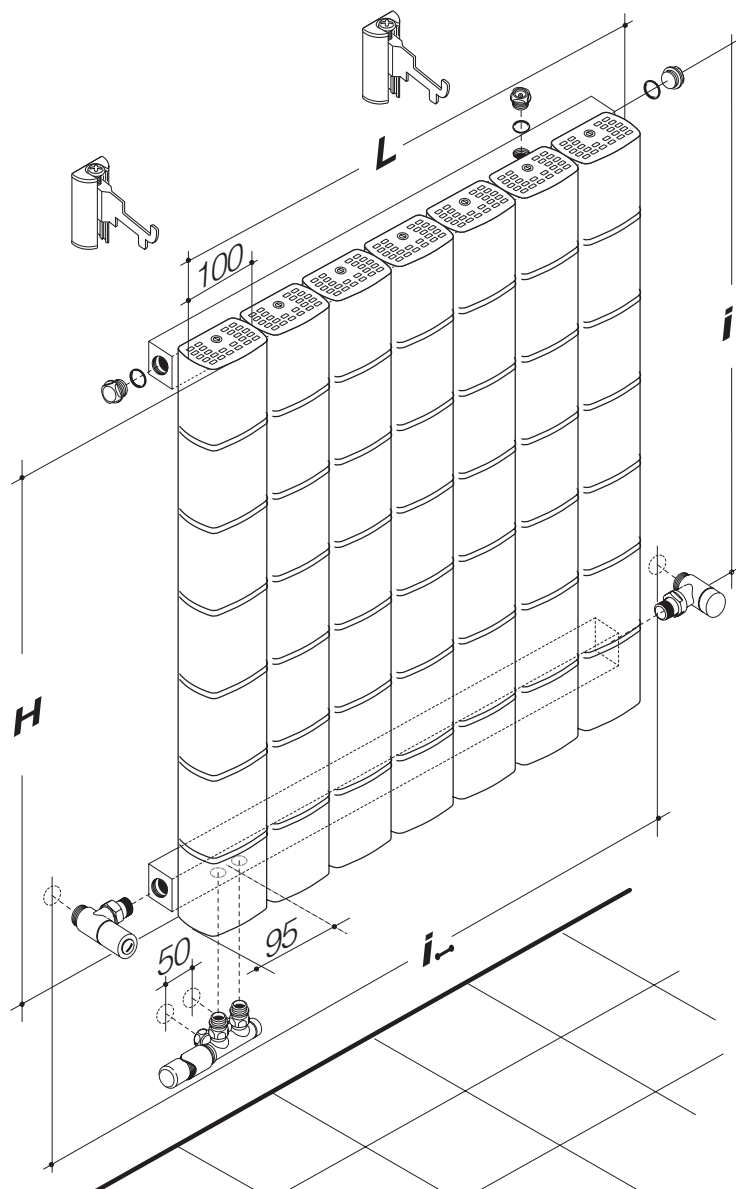

ACCESSORI / ACCESSORIES

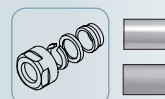

Kit raccordi (pag.159)
 Fittings



Kit base di elettrificazione
 (riempimento e resistenza)
 Electrification kit
 (filling and electric element)
 Termostati / thermostats pag.139

CONNESSIONI / CONNECTIONS



*Inserendo il diaframma fornito a kit
 *By mounting the diaphragm

In sede d'ordine é importante specificare il tipo di raccordo (ferro, rame, multistrato o polyetilene) e il suo diametro.
 While ordering, it's important to specify fittings type (for iron, copper, multilayer or plastic pipes) and their diameter.